

EN Built-in partition fan (Axial fan)
Passport/Service instruction



VZ-QF-C



VZ-SF-C



VZ-S-C



VZ-QUADC



VZ-PF



VZ-DF-BB

**Attention!**

Before using the appliance please read the contents of this instruction.

**Attention!**

Children of 8 years old and upward intend this appliance for use and persons with reduced physical, sensory or mental capabilities, or lack of knowledge, unless a person responsible for their safety has given them supervision or instruction concerning the use of the appliance. Children should be supervised to ensure that they do not play with the appliance. Cleaning and service of the device shouldn't to be made by children without supervision.

Safety requirements

Base on type of protection from electric shock the fans relate to the devices of class II (220-240 V ~ 50/60 Hz). When connecting the fans to the AC mains with a frequency of 60 Hz, the technical characteristics may change. Check them with the manufacturer. The climate category «moderately cold» Type «4» (YX/L4). The level of protection against solid objects and water is IP 24 (GOST 14254-2015 (IEC 60529:2013)).

**Attention!**

Specialists, who have a special allowance for such types of work, shall do connection of the fans to power supply. The temperature of fan exploitation cannot exceed the indicated range (from +1C to +40C). Avoid the installation of the fan to one ventilation main line with smoke-deflecting pipe from devices, having fuel burners. In case of maintenance diagnostics, turn off the automatic breaker (S1 in OFF position) and call an electrician.

**Attention!**

All actions for connection, set up, maintenance and repair of the product have to be carried out only at mains voltage removed (S1 in OFF position).

One-phase main, to which the fan is connected, must correspond to the norms in force. Stationary electric wiring must be equipped with an automatic circuit breaker (S1 in the scheme). The connection is carried out through the switch (S2 in the diagram) that is built into the stationary wiring. The gap between switch contacts at all poles must be not less than 3 mm. Before installation, it is necessary to make sure that there is no visible damage of impeller, case, grill, and the flow passage of the case has no any extraneous things, which may damage impeller blades.

Correct use

Axial duct domestic electric fan, axial duct domestic removable electric fan is designed to remove odors and excess moisture from toilets, bathrooms and other small rooms, required ventilation.

Attention!

For the purposes of maintenance or complete replacement of the equipment, all fans must have detachable fixing.

SYMBOL LEGEND OF OPTIONS

Legend	Name
AT	Axial duct domestic removable electric fans with timer.
HT	Axial duct domestic removable electric fans with humidity sensor.

Additional options can be combined or absent.

VZ-QF-C / VZ-SF-C / VZ-S-C / VZ-QUADC

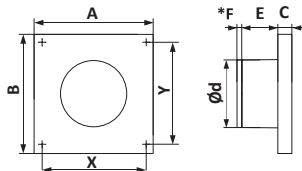

*- This size is present only in fans with "back flow valve" option

Model	d	A	B	X	Y	E	F*	C
VZ100-QF-C	100	155	155	135	135	70	7	24
VZ125-QF-C	125	175	175	155	155	78	8,5	24
VZ150-QF-C	149,5	205	205	183,5	183,5	108	—	28
VZ100-SF-C	100	155	155	135	135	70	7	31
VZ125-SF-C	125	175	175	155	155	78	8,5	32
VZ150-SF-C	149,5	205	205	183,5	183,5	108	—	37
VZ100-S-C	100	150	150	130	130	50	6	25
VZ125-S-C	125	175	175	155	155	61	6	26
VZ150-S-C	150	200	200	180	180	62	6	28
VZ100-QUADC	98	172	172	135	135	74	6	38
VZ125-QUADC	123	200	200	160	160	79	6	38

VZ-PF

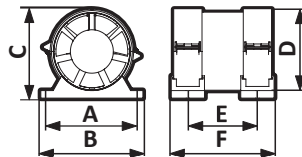

Model	A	B	C	D	E	F
VZ100-PF	122	138	119	103,6	94	139
VZ125-PF	147	163	144	128,6	101	146
VZ160-PF	182	198	179	163,6	104	154

VZ-DF-BB

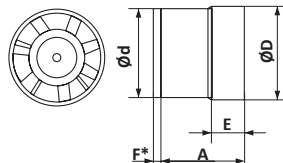

Model	d	D	A	E	F*
VZ100-DF-BB	100	103	80	30	5
VZ125-DF-BB	125	128	87	30	7
VZ150-DF-BB	150	153	104	35	10

MAIN TECHNICAL CHARACTERISTICS

Characteristics	Flange diameter (mm)	Speed	Efficiency (m ³ /h)	Power consumption (W)	Noise level (dBA)	Net weight (kg), doesn't exceed
VZ100-QF-C	100	—	90	8,4	25	0,45
VZ125-QF-C	125	—	180	10	30	0,65
VZ150-QF-C	149,5	L1	220	18	28	1,0
		L2	320	20	33	
VZ100-SF-C	100	—	90	8,4	25	0,45
VZ125-SF-C	125	—	180	10	30	0,65
VZ150-SF-C	149,5	L1	220	18	28	1,0
		L2	320	20	33	
VZ100-S-C	100	—	97	14	35	0,44
VZ125-S-C	125	—	183	16	36	0,5
VZ150-S-C	150	—	290	16	38	0,63
VZ100-QUADC	98	—	90	16	35	0,5
VZ125-QUADC	123	—	140	20	36	0,65
VZ100-DF-BB	100	—	107	14	35	0,31
VZ125-DF-BB	125	—	190	18	36	0,41
VZ150-DF-BB	150	—	280	20	37	0,60
VZ100-PF	100	—	115	14	32	0,51
VZ125-PF	125	—	195	18	34	0,55
VZ160-PF	160	—	320	22	36	0,87

The fans are designed for connection to AC mains voltage 220-240 V, frequency 50/60 Hz.

- L1 – Low Speed
- L2 – High Speed

INSTALLATION AND SET UP PROCEDURES

Fans are mounted both with airvents and independently.

Fans are intended for wall and ceiling mounting. Mounting of fans is carried out as with ventilating air ducts and independently on a plain vertical or horizontal surface. Tolerance range of a mounting surface in vertical and horizontal directions is $\pm 0,5$ mm.

Legend of circuit breaker S1 on the scheme

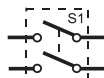

Circuit breaker S1



Legend of external switch S2 on the scheme

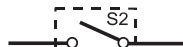

External switch S2

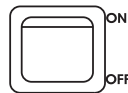

SCHEMATIC DIAGRAMS OF FAN'S CONNECTION

Scheme 1

of fan connection (base model)
X- terminal block, 2 pairs

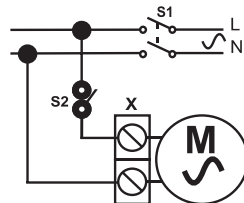

Scheme 2 (for VZ150-QF-C, VZ150-SF-C models)

of fan connection, equipped with - 03 option (two-speed). X- terminal block, 3 pairs

• L1 – Low Speed

• L2 – High Speed

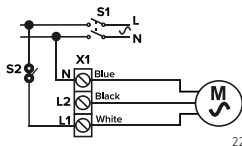

220-240V

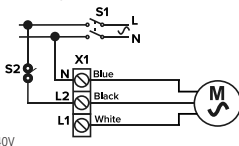

WIRING DIAGRAM CONNECTION OF FANS TO THE NETWORK

Connection of fan to the network shown in pic. 1-4

VZ-SF-C / VZ-QF-C (pic. 1-2), VZ-QUADC (pic. 3), VZ-S-C (pic. 4)

- remove the decorative front panel
- hold the power wire through the cable hole 1 in the case
- strip the insulation on 5-7 mm from the wire end
- insert wires into terminal box X and press them by tap screw (for connection of VZ150-QF-C / VZ150-SF-C see fig. 2 and electric scheme 2)
- fix the wires by means of cable clamp 2
- combine clamps of the decorative panel with grooves in the case
- fix the panel with screw

Pic.1 VZ-SF-C / VZ-QF-C

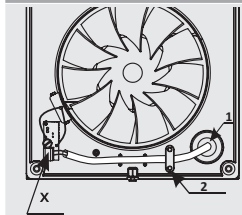

Pic.2 VZ150-SF-C / VZ150-QF-C

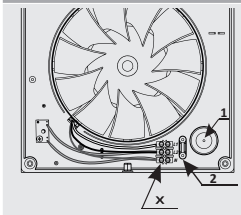

Pic.3 VZ-QUADC

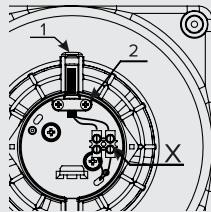

Pic.4 VZ-S-C

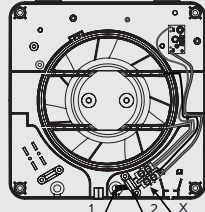

VZ-PF (Pic. 9, 11)

- remove the terminal block cover;
 - hold the power wire through the cable hole 1 in the case
 - strip the insulation on 5-7 mm from the wire end insert wires into terminal box X and press them by tap screw;
 - fix the wires by means of cable clamp 2;
 - install the cover of terminal block.
- Install brackets of holders;
 - Install first couple of covers in brackets ;
 - Install the fan ;
 - Butt airvents from two sides to the fan case
 - Fix the fan case with airvents by means of another couple of covers.

Pic.9 VZ-PF

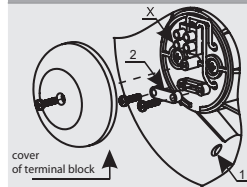

Pic.11 VZ-PF

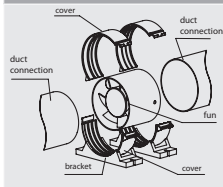

VZ-DF-BB (pic. 16-17)

- remove the protective cover;
- hold the power wire through the cable hole 1 in the case;
- strip the insulation on 7-8 mm from the wire end
- insert wires into terminal box X and press them by tap screw
- fix the wires by means of cable clamp 2
- install the protective cover;
- install the grill.

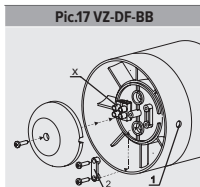

Fans of VZ-DFseries have different diameters of inlet and outlet pipes for the connection of diffusers with the flange of the corresponding diameter from absorption and air ducts from air side discharge.

- Install a duct fan;
- From absorption, accession of air ducts to the fan is possible through fittings of a necessary form and diameter or a decorative grill with a flange.

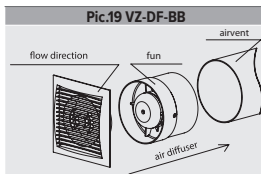
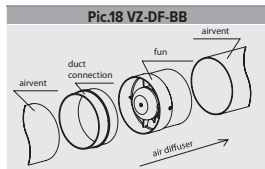
**Possible problems and solutions**

Malfunction	Probable cause	Remedy
When connected to the power grid, the fan does not rotate, does not respond to controls.	The mains supply is not connected.	It is necessary to consult a specialist.
	Internal connection fault.	
Low air flow.	The ventilation system is clogged.	Clean the ventilation system.
Increased noise or vibration.	The impeller is blocked.	Clean the impeller.
	The fan is not fixed or incorrectly mounted.	Correct the installation error.
	The ventilation system is clogged.	Clean the ventilation system.

**ATTENTION!**

The fan and the service controlling equipment has to be isolated from power supply during the installation time and service.

Maintenance

- disconnect the fan from the mains;
- remove the fan by disconnecting it from the duct and removed from the installation place.
- in case of heavy soiling, remove the fan impeller;
- wipe all plastic components with a soft cloth soaked in soapy water, it is not allowed transfer of washing solution to the motor;
- wipe all surfaces dry;
- assemble a fan and set it in place.

Storage and transportation

Keep the fan only in the packaging of the manufacturer in a ventilated room at a temperature of +5 ° C to +40 ° C and relative humidity of 80% (at T = 25 ° C). Keeping time - 5 years from date of manufacture. Products transported by any transport provided consumer protection or transport container from the direct effects of rainfall, lack of bias transport places during transport, the lack of mutual physical impact during transportation and preservation of fans. Transportation is carried out in force with the rules for this transport.



Utilization

This appliance has a label in accordance with European Directive 2012/19/EU on waste electrical and electronic appliances (waste electrical and electronic equipment - WEEE). This order acts on rules on the territory throughout the EU and recycling of old appliances.

Service lifetime Established service period - 5 years

Warranty

Fans are made by in accordance with applicable regulations and standards.

Manufacturer guarantees the normal operation of the fan for 5 years from the date of sale in retail outlets subject to the rules of transportation, storage, installation, operation and other requirements of this instruction. In case of absence of the date of sale, the warranty period will be computed from the date of manufacture.

In case of finding failures in the work of the fan on the fault of manufacturer during the warranty period the consumer has the right to replace the fan in the factory that is the same serial numbers on the product and in the passport. An availability of branded factory nameplate on the device is required! Please make sure it is available and store it on the device during its lifetime.

To confirm the date of purchase for warranty service or presentation of other legal

requirements urge you need to retain proof of purchase (cheque, receipt, and other documents confirming the date and place of purchase).

The good meets the requirements:

Directive 2014/35/EU (Low Voltage) Standards: IEC 60335-2-80:2015; IEC 60335-1:2010, AMD1:2013; AMD2:2016; EN 60335-2-80:2003+A1:2004+A2:2009;
 Directive 2014/30/EU (Electromagnetic compatibility) - CISPR 14-1; IEC 61000-3-2; IEC 61000-3-3; CISPR 14-2 (IEC 61000-4-2; EN 61000-4-4; EN 61000-4-5; EN 61000-4-6; EN 61000-4-11)

Delivery set

- the assembled fan
- passport/operation instruction, box packaging
- dowel with screws - 4 PCs. (for fixing the fan) (except for VZ-DF, VZ-PF)
- screws - 2 PCs (for mounting brackets) (except for VZ-DF, VZ-PF)
- bracket - 1 PC. (except for VZ-DF, VZ-PF)
- insect screen - 1 PCs. (for models VZ-S-C)

Thank you for choosing us!

Approval certificate

The fan is recognized suitable for operation

Sold

Name of company, shop stamp:

Sale date _____

Date manufacture: _____

Mark of Quality Department : _____

Manufacture / Replacement will be made at the following address

DuctStation Ltd
Unit 2-3 Brandon Business Centre,
Putney Close, Brandon.
Suffolk - United Kingdom
IP27 0PA

Tel: +44(0)33 00 430 320
Web: www.VentZone.co.uk
Email: Support@VentZone.co.uk

Manufacturer reserves the right to make changes without notification

Edition from 12.2023