



## VZ-MFF-High Pressure Mixed Flow Fan



- The high pressure mixed-flow in-line fan is designed for supply and exhaust ventilation systems.
- It is designed for duct mounting with air ducts of the appropriate diameter at any point of the ventilation system and at any angle.
- Exhaust or supply ventilation depending on the fan installation in the system.
- The fan casing is made of high quality and durable plastic.
- Sealed mounting box.
- Single-phase motor with external rotor is equipped with high-tech design high pressure axia fan. It has built-in thermal protection with automatic restart.
- It is attached to the wall or ceiling using anchor brackets (not in the set).
- Speed adjustment is possible. It can be either smooth or stepped and carried out using a thyristor or autotransformer regulator. Several fans can be connected to one control device, provided that their total power and operating current do not exceed the nominal parameters of the regulator.
- Ingress protection rating for the electrical equipment against solids and water—IP24, for the motor—IP44.



Features a high static pressure mixed flow design, combined with AC External Motors or PWM controlled EC-motors to ensure a quiet and energy efficient performance

The VentZone mixed flow duct fan system is designed to vent the air by transfer of heating/cooling and exhaust odors of hydroponic growing rooms, bathrooms, living rooms, kitchens and similar places.

Fan Colour	Grey ,White or Custom
Impeller Material	High Structer ABS Plastic
Body Material	High Structer ABS Plastic
Working Temperature	-20 - +60 °C
Standards	EN 60335-2-80

Motor Insulation Class	H Class
Motor Bearing System	Ball Bearing
Motor Winding	100 % Copper Wire
Motor Type	AC External Rotor-Motor
Motor Brand	VentEurope



### Specifications

MODEL	VOLTAGE (V)	FREQUENCY (Hz)	POWER (W)	FAN SPEED (rpm/min-1)	FLOW RATE (m <sup>3</sup> / h)	Noise level, db(A)
VZ-100-MFF	230	50/60	54	2148	203	39
VZ-125-MFF	230	50/60	56	2190	298	44
VZ-150-MFF	230	50/60	75	2110	444	46
VZ-160-MFF	230	50/60	75	2137	490	47

Values are for 0 Pa

### Applications

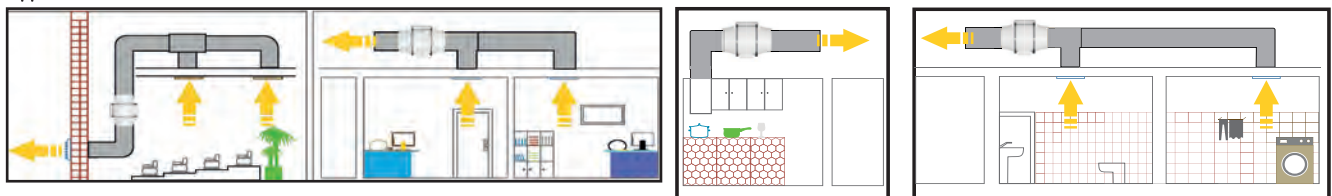



VZ-MFF-High Pressure Mixed Flow Fan

Dimensions

MODEL	A	B	C	D	E
VZ-100-MFF	96	306,5	215	60	80
VZ-125-MFF	121	260	215	60	80
VZ-150-MFF	146	290,5	242	60	80
VZ-160-MFF	156	271	242	60	80

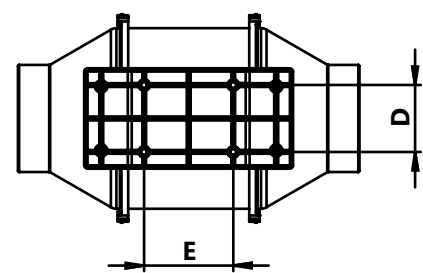
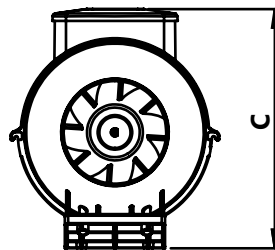
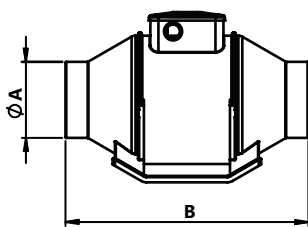

VZ-MFF-100

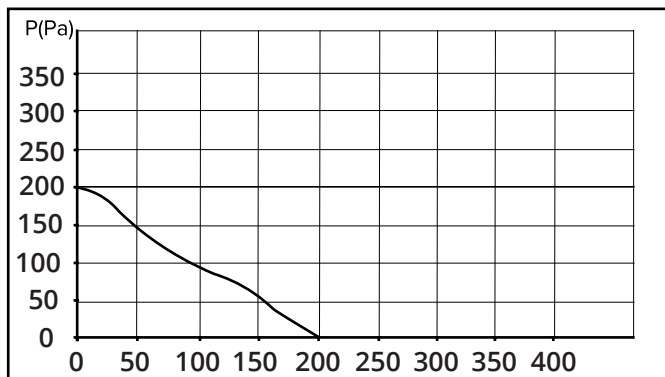

VZ-MFF-125

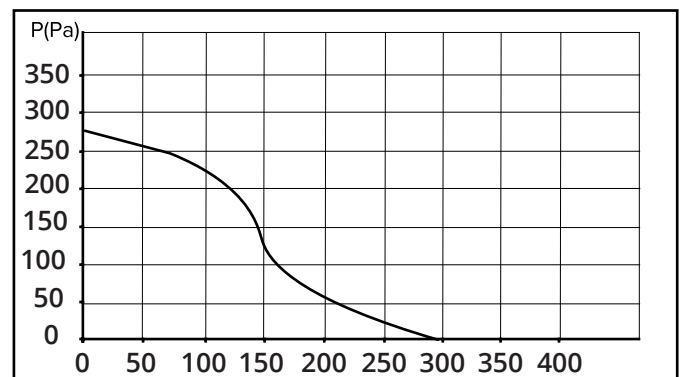

VZ-MFF-150

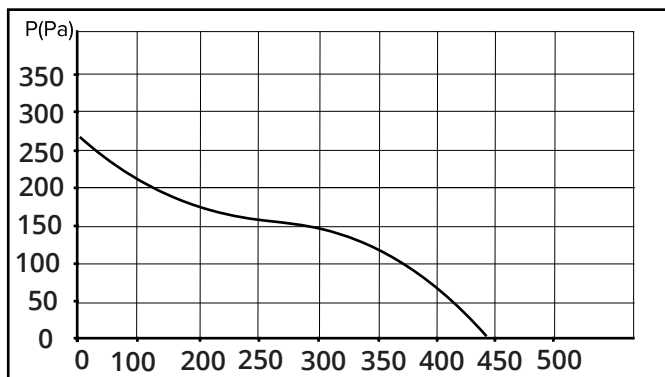

VZ-MFF-160

